



# The Heritage

Heritage Chapter Bluebills  
Boeing Retiree Volunteer Newsletter

October 2022

WWW.BLUEBILLS.ORG

VOLUME 28 ISSUE 10



## Chairman's Comments- October 2022

*By Richard Vaughn*

I have no comments this month but look forward to seeing many of you at our next meeting on October 28th. Jim Beasley has obtained a great presentation for us in October, from the Museum of Flight.

*Richard*



## Presentation for - October 28th General Meeting

*By Jim Beasley*

We will have a presenter from the Museum of Flight who's topic will include early history from it's founding, the current status, and it's future.

*Jim*

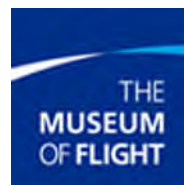

## September Meeting Summary

*By Mary Ulibarri*

Richard welcomed some additional attendees to this month's meeting -- good to see more folks. He then proceeded to lead the Pledge of Allegiance. There were two September birthday members in attendance -- Don Hilt and Norma Vaughn. Others on my list are John Mah, Jim Lee, Lisa Nyreen and Marcia Phelps. There was one September anniversary -- the Hilts.

Richard reported we have a new Boeing coordinator, Cory Ertel, who has reached out, but a meet-up has yet to be worked out. The office computing system is still on hold -- no access at

this time. Despite that, members are encourage to submit volunteer time to Mary at [marybarri20@gmail.com](mailto:marybarri20@gmail.com) or Dick Beham at [bbbeditor@live.com](mailto:bbbeditor@live.com).

Doug Hoople stated the USO has opened their facilities on a parttime basis, so volunteers are being sought again to help out. The hours are Monday, Wednesday, Saturday 8:00 am to 4:00 am (the next morning) and Thursday 8:00 am until midnight. Go to USO SeaTac and look under the heading Volunteer to sign up.

It was announced the Busy Bs were raffling off all three of the quilts, not just the one as originally planned. There was a quick rush to buy more tickets and then the three drawings were held. The winners were:

Don Hilt,



Donna Crueger



and



Sharon Hagen.

Congratulations!

Jim Beasley stated the Woodland Park Zoo representative was unable to speak at the meeting as planned, but provided four pairs of admittance tickets to the Zoo, which were raffled after the quilts. Richard then held the door prize drawings and adjourned the meeting..

## **“I Fell for a Scam”**

*By: Lonnie Stevenson*

I, Lonnie Stevenson, of all people should know better. I received a text early one morning, I just wanted to shut off the notification sound on my cell phone.

So, I got up thinking it may be from my son, read the text, and what I read was something like Please call BECU to verify a charge on your account at some blah blah (800 or 886 number).

Well, I panicked, and being still half asleep I called the number. (Stupid, dumb, stupid).

They wanted my SS number, I gave them A FONEY number, they said, and not a valid number, let's try something else. . . which I guess I gave them. .and they said, “Your account has been validated.”

### **BIG MISTAKE**

Then I really panicked and woke up for real and called the real BECU phone number, and had to get a new VISA card.

**ALWAYS**  
**CALL THE REAL COMPANY PHONE NUMBER**  
**NEVER**

CALL A PHONENUMBER IN A TEXT OR EMAIL OR CLICK ON A LINK IN A TEXT OR  
 EMAIL

## Busy B's

*By Sibyl Fletcher*

## Busy Bs

P	S	C	O	L	O	R	F	U	L	J	S	G	D
G	M	A	T	S	T	I	G	E	W	A	T	S	I
J	A	I	F	I	S	R	N	V	A	N	A	E	E
I	K	G	I	T	E	E	I	I	R	I	R	W	A
C	I	R	B	A	F	P	Y	T	M	C	T	O	Q
A	N	T	T	N	N	E	F	A	A	E	A	N	G
C	G	B	E	D	R	T	S	E	N	H	G	L	R
U	B	A	U	C	L	I	I	R	D	A	A	A	E
P	L	T	N	H	X	T	T	C	C	W	I	B	L
O	O	T	I	A	O	I	A	Q	O	E	N	E	A
F	C	I	Q	T	E	V	S	D	Z	S	T	L	X
T	K	N	U	L	Y	E	A	Q	Y	V	A	N	I
E	S	G	E	D	O	N	A	T	I	O	N	S	N
A	T	R	E	P	P	I	R	E	H	T	T	E	G

JANICEHAWES  
 BATTING  
 COLORFUL  
 GETTHERIPPER  
 FABRIC  
 WARMANDCOZY  
 DONATIONS  
 STARTAGAIN  
 SEWONLABEL  
 SATISFYING  
 MAKINGBLOCKS  
 CUPOFTEA  
 REPETITIVE  
 RELAXING  
 CREATIVE  
 UNIQUE  
 SITANDCHAT

Play this puzzle online at : <https://thewordsearch.com/puzzle/4050165/>

## EASTSIDE HERITAGE CENTER



Connections for yesterday, today, and tomorrow.

## East Side Stories

### Fred Eitel and Lochleven's Earliest Days

*BY Margaret Laliberte, Eastside Heritage Center Volunteer*

A note on the back of a photo from the 1920s showing swimmers relaxing in Meydenbauer Bay identifies their location as "Rogers Beach, 96th, west of Eitel Beach." Where could that be? The Polk Eastside Atlas of 1945 identified parcels owned by Fred J. Eitel and another by Sarah Rogers, lying between the bay and Lake Washington Boulevard, south of 96th Ave. N.E. and west of what later became the first Meydenbauer Beach Park in 1953. That was the heart of the Lochleven neighborhood, which owed its existence to Fred Eitel and his co-officers of the Bellevue Land Company, William Norris and F. A. Sutphen. By 1906 Eitel had purchased several parcels and conveyed them to the newly incorporated company. A plat map was filed with the county in 1907.



*Swimmers at Rogers Beach in Meydenbauer Bay in the 1920s. It is likely that some of them may be members of the Eitel family. (2001.114.026)*

At that time Eitel was already an up-and-coming property developer in Seattle. In 1904, when the massive Second Denny regrade project was underway on Second Avenue, he and his brother David had begun building the six-story Eitel Building on the corner of Second Avenue and Pike Street. Completed in 1906, it housed the largest passenger elevator in the Northwest at the time. A photo shows the building under construction while Second Avenue just to the North was only a track winding among piles of dirt and debris. The building was one of numerous substantial new buildings in the developing area the Seattle Daily Times called a "handsome retail district." In coming years Fred Eitel owned significant buildings in the city's core and in the newly reclaimed "tide lands." In an ad for a real estate investment firm in which he was a shareholder, Eitel was described as "a real estate expert and man of affairs."

Over in Meydenbauer Bay the Lochleven development got underway in 1906, advertised frequently in both the Seattle Daily Times and Post-Intelligencer newspapers. Initially the developers had a grand vision. A Times article described "a broad esplanade for the waterfront with a

*(Continued on page 5)*



heavy retaining bulkhead, concrete walks, parks, parking strips, piers, boat houses, graded streets and a water system.” This would be a district of attractive homes from which apartments and businesses would be barred and a single distinctive “English” style of architecture would prevail throughout. Another ad assured readers that the developers were catering to “discriminating buyers who wish not to be surrounded by shacks.” An illustration showed a large dock with a Craftsman-style pavilion. Over the summer free excursions by steamer were offered. Potential buyers were cautioned not to expect to see the old English houses or Kenwood Boulevard along the waterfront—yet. (A few months later promised improvements were apparently scaled back, as ads mentioned only graded streets, cement sidewalks and water mains.)

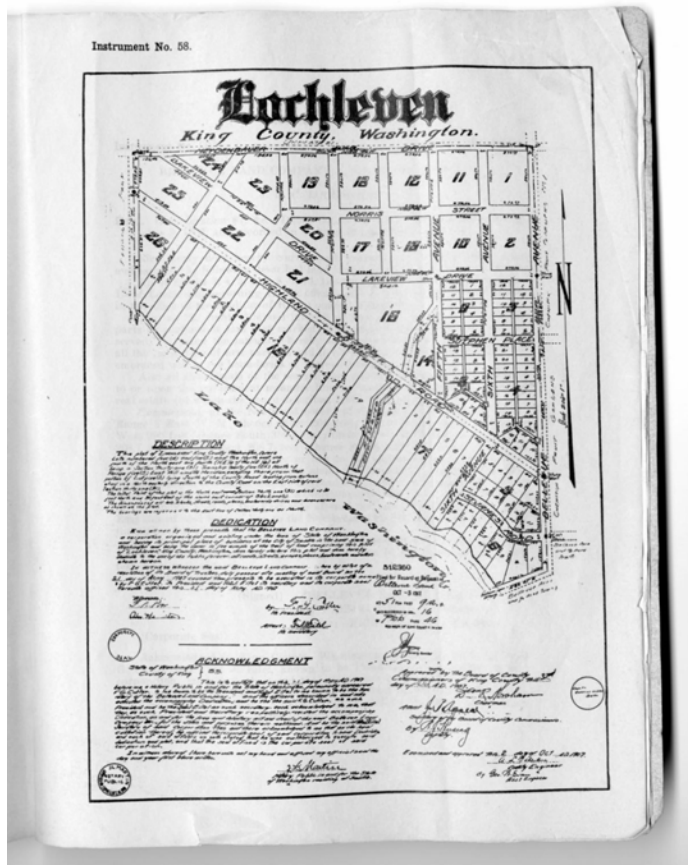

*Plat of Lochleven. The subdivision's boundaries are Meydenbauer Bay and streets now known as 92nd Ave. N.E., N.E. 8th St. and 100th Ave. N.E. (Dawes 2003.003)*

Lochleven's marketing efforts alternated between promoting an attractive residential development and suggesting downright land speculation. The ship canal and locks were on the horizon—construction began in 1911—and even in 1906 newspaper ads suggested that the lowering of the lake would probably add 50 to 100 of land to Lochleven waterfront parcels. As the so-called Eastern shore built up, property values would soar, readers were assured.

Perhaps the most unusual example of speculation was the sale of a parcel of Lochleven waterfront property in 1919 to the American Pacific Whaling Company. A wharf was built, and the company's ships in the Alaska whaling industry over-

wintered there until 1942. (The parcel later became part of today's Meydenbauer Bay Park.) The company founder's grandson reminisced that when the company moved to town, Bellevue “was way out in the sticks and there was no objection to a commercial enterprise in Meydenbauer Bay.”



*Eitel family home in Lochleven in 1922, looking west towards Medina. The steamer on Meydenbauer Bay is the “Atlanta,” just one of the small ferries servicing East shore communities. (Dawes 2003.003)*

*(Continued on page 6)*

Lochleven developed slowly over the years. In 1918 Eitel and his wife Ruby moved their family of four children to their new home there. They became active members of the growing Bellevue community. Ruby was active in the Bellevue Women's Club in the 1920s, the girls in the Junior Division of the Fruit and Flower Mission (which ultimately became Bellevue LifeSpring). Fred served on the board of the school district and was a founding officer of the Bellevue Water Company. In 1938 he died of injuries from being hit by a car as he stepped from the bus on his way home. He was 71. Ruby had died of illness nearly three years earlier.

Fred Eitel's legacy is evident on both sides of the lake today. The Eitel Building still stands, having survived years of deterioration, boarded-up windows, and a threat from the City to demolish it. Its latest owners completely restored it, to the tune of \$16 million, and it is now the State Hotel, from whose rooftop deck guests look over the Pike Place Market to Elliott Bay. Lochleven is still a quiet green neighborhood. It lacks the beachfront promenade—and for the most part the promised paved sidewalks. It has an active community association, though. Voting membership is based on residence within the boundaries of the original 1907 plat map.

## **News from the Social Security Administration**

*Submitted by: Micki Brown*

Dear Colleague,

Do your clients need to apply for a Social Security number and card? Do they need a replacement card or to update their name? We now have a new – and faster – way for them to make the request online.

When your clients visit our [Social Security Number and Card webpage](#), they can answer a series of questions that will determine whether they can:

- Complete the entire application process online; or
- Start the application process online, then bring any required documents to their local office to complete the application. This saves them time in the office.

In both scenarios, we will mail their card after we process their completed application, typically within two weeks. Please remind your clients that we don't issue cards at our offices or card centers.

More information about this process is available in our [blog post](#).

Please share this information with your family, friends, and clients.

Sincerely,

Jeffrey Buckner  
Associate Commissioner  
Office of Strategic & Digital Communications

## Bits & Pieces

Money used to talk, then it whispered -  
now it just sneaks off

Nothing makes them the good, old days  
so much as not remembering them  
very well

I'd like to have an electric car, cause  
"Charge it" is my favorite clause.

One objection to voting a split ticket -  
you can't be sure which party to  
blame.

Wife to husband as she watched him  
rummaging through the refrigerator, "If  
you're looking for the fish you caught, I  
froze it in an ice cube."

Running into debt ain't so bad. It's  
running into creditors that hurts!



## Calendar of Events 2022

### In Person Meetings

<i>Jan 28</i>	<i>Chapter Monthly Meeting</i>
<i>Feb 25</i>	<i>Chapter Monthly Meeting</i>
<i>Mar 25</i>	<i>Chapter Monthly Meeting</i>
<i>Apr 29</i>	<i>Chapter Monthly Meeting</i>
<i>May 27</i>	<i>Chapter Monthly Meeting</i>
<i>Jun 24</i>	<i>Chapter Monthly Meeting</i>
<i>Jul 29</i>	<i>Chapter Monthly Meeting</i>
<i>Aug 26</i>	<i>Chapter In-Door Picnic</i>
<i>Sept 30</i>	<i>Chapter Monthly Meeting</i>
<i>Oct 28</i>	<i>Chapter Monthly Meeting</i>
<i>Nov 18</i>	<i>Chapter Monthly Meeting</i>
<i>Dec 16</i>	<i>Chapter Monthly Meeting</i>

## Food Bank Schedule For 2022

Cash donations collected at each monthly meeting to be given to a different food bank each month.

<i>January</i>	<i>Highline</i>	<i>Heinz Gehlhaar</i>
<i>February</i>	<i>Bellevue</i>	<i>Doug Hoople</i>
<i>March</i>	<i>Federal Way</i>	<i>Lonnie Stevenson</i>
<i>April</i>	<i>Maple Valley</i>	<i>Vaughn's</i>
<i>May</i>	<i>Kent</i>	<i>Melinda Stubbs</i>
<i>June</i>	<i>Auburn</i>	<i>Martha Battles</i>
<i>July</i>	<i>West Seattle</i>	<i>Heinz Gehlhaar</i>
<i>August</i>	<i>Tacoma</i>	<i>(open)</i>
<i>September</i>	<i>Renton</i>	<i>Eleanor Skinner</i>
<i>October</i>	<i>White Center</i>	<i>Heinz Gehlhaar</i>
<i>November</i>	<i>Des Moines</i>	<i>Lonnie Stevenson</i>
<i>December</i>	<i>Issaquah</i>	<i>Eleanor Skinner</i>

**Bluebills - Heritage Chapter**  
**PO Box 3707 M/C 1K-B02**  
**Seattle, WA 98124**  
**(206) 544-6286**

e-mail: [bluebills@boeing.com](mailto:bluebills@boeing.com)

Web Site: [www.bluebills.org](http://www.bluebills.org)

**Richard Vaughn** **Vice-Chairman**  
[rhvaughn32@icloud.com](mailto:rhvaughn32@icloud.com)

**(Open)** **Vice-Chairman**  
[bluebills@boeing.com](mailto:bluebills@boeing.com)

**(Open)** **Agency Relations/  
Volunteer Coordinator**  
[bluebills@boeing.com](mailto:bluebills@boeing.com)

**Lonnie Stevenson** **Public Relations**  
[icebear01@comcast.net](mailto:icebear01@comcast.net)

**Norma Vaughn** **Office Manager**  
[abbyrose00@msn.com](mailto:abbyrose00@msn.com)

**(Open)** **Community Outreach**  
[bluebills@boeing.com](mailto:bluebills@boeing.com)

**(Open)** **Education**  
[bluebills@boeing.com](mailto:bluebills@boeing.com)

**Marcia Phelps** **Historian**  
[mlp14331@hotmail.com](mailto:mlp14331@hotmail.com)

**Dick Beham** **Computers**  
[bluebills@boeing.com](mailto:bluebills@boeing.com)

**Dick Beham** **Newsletter—Webmaster**  
[bbbeditor@live.com](mailto:bbbeditor@live.com)

**Mary Ulibarri** **Newsletter Co-Editor**  
[marybarri20@gmail.com](mailto:marybarri20@gmail.com)

**Janice Hawes** **Busy B's**  
[j.s.hawes@comcast.net](mailto:j.s.hawes@comcast.net)

**Jim Beasley** **Speaker Coordinator**  
[jimcarlab@hotmail.com](mailto:jimcarlab@hotmail.com)

**(Open)** **School Supplies for Children**  
[bluebills@boeing.com](mailto:bluebills@boeing.com)

**Don't Forget to  
Report Your Hours!**



# Bluebills Heritage Chapter Meeting

**October 28, 2022**

**Social 10:00AM, Meeting 10:30 - 11:30 AM**

**Speaker: Presenter from Museum of Flight**

**Subject: "Early history from it's founding, the current status, and it's future."**

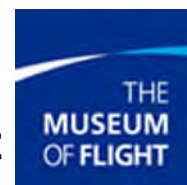

*(Bring a non-perishable food item to monthly meetings to be given to a different food bank each month.)*

The Bluebills monthly meetings are held at the VFW Post 1263, 416 Burnett Ave South, Renton, WA. Parking is available in the lot immediately across the street from the VFW.

## Bluebills Monthly Volunteer Hours

**Volunteer Name** \_\_\_\_\_

**Phone Number** \_\_\_\_\_

**Hours worked** \_\_\_\_\_

(month/year)

**For** \_\_\_\_\_

(agency name)

**Hours worked** \_\_\_\_\_

(month/year)

**For** \_\_\_\_\_

(agency name)

**Hours worked** \_\_\_\_\_

(month/year)

**For** \_\_\_\_\_

(agency name)

Please send completed hours form to Bluebills, PO Box 3707 1K-B02, Seattle, WA 98124  
Email to [bluebills@boeing.com](mailto:bluebills@boeing.com) or bring to Bluebills monthly meeting